

This printed quick guide provides a quick walkthrough of the set up process.

**Technical Spec**

<b>Net weight</b>	0.75 kg (1.65 lbs)	
<b>Dimension (W * H * D)</b>	157 mm x 216 mm x 136 mm (6.18" x 8.50" x 5.35")	
<b>Screw type</b>	M4	
<b>Material</b>	Steel	
<b>Hinge module</b>	Tilt	-23° ~ +151°
	Rotating holder (pivot)	360°
<b>Display support</b>	Mounting pattern	100 mm x 100 mm / 75 mm x 75 mm
	Suggested signboard size	≤ 12"
	Maximum support weight	1.2 kg (2.6 lbs)
<b>Cable Management</b>	Yes	

**Box Content**

Item	Parts	Q'ty
1	Table stand	1
2	Table mounting screw	2
3	VESA plate screw (WRP-1000 use M4 x 12L)	4



**Mounting and installation**

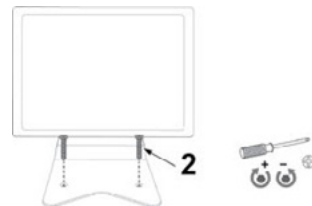
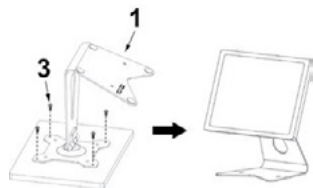

**Mechanical Drawings**

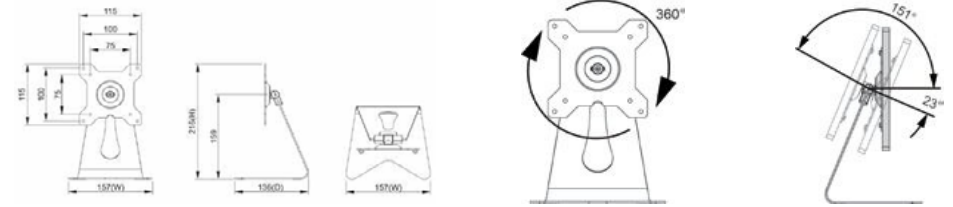

**Product Photos**



Front



Back

10" signboard in landscape



ACM-030TS Black



Anti-slip surface for secure mounting